

# FULL EXTENSION SLIDE (W/HOLD-OUT DETENT)

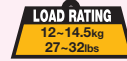

AR3-K

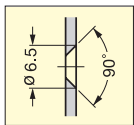
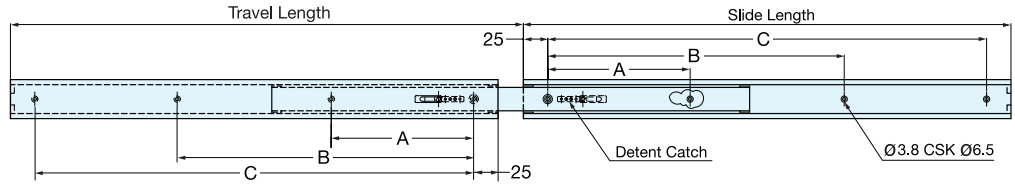
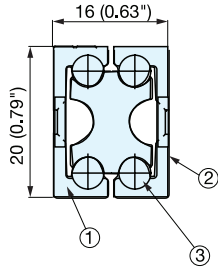

Hole Dimension (Outer Rail)

- Full extension
- Positive stop
- Non-handed
- Hold-out detent

25.4mm=1"

No.	Part	Material	Finish
①	Outer Rail	Aluminum	White Anodized
②	Inner Rail		
③	Balls	Steel	-

Item No.	Slide Length	Travel Length	A	B	C	Load Rating (kg/pair)	Weight (g)	Box (pcs)
AR3-K200	200 ( 7-7/8" )	214 ( 8-53/64" )	150	-	-	14.5 (32 lbs)	133	30
AR3-K300	300 ( 11-13/16" )	314 ( 12-23/64" )	130	250	-	14 (31 lbs)	199	
AR3-K400	400 ( 15-3/4" )	414 ( 16-19/64" )	130	280	350	13 (29 lbs)	265	
AR3-K500	500 ( 19-11/16" )	514 ( 20-15/64" )	130	280	450	12 (27 lbs)	330	20

# 3/4 EXTENSION SLIDE (W/HOLD-OUT DETENT)



AR2-K

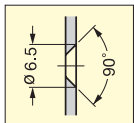
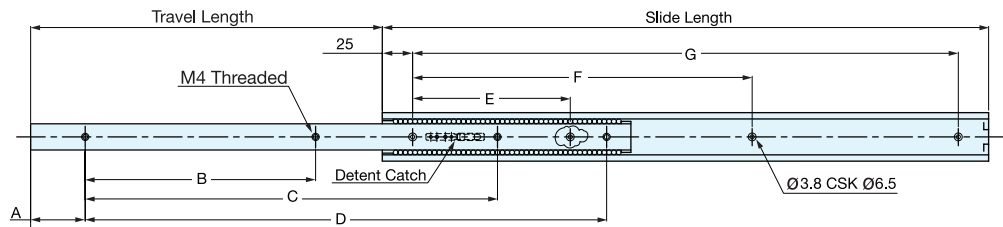
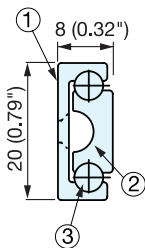

Hole Dimension (Outer Rail)

- 3/4 extension
- Positive stop
- Non-handed
- Hold-out detent

25.4mm=1"

No.	Part	Material	Finish
①	Outer Rail	Aluminum	White Anodized
②	Inner Rail		
③	Balls	Steel	-

Item No.	Slide Length	Travel Length	A	B	C	D	E	F	G	Load Rating (kg/pair)	Weight (g)	Box (pcs)
AR2-K200	200 ( 7-7/8" )	110 ( 4-7/16" )	25	60	160	-	150	-	-	18 (40 lbs)	68	50
AR2-K300	300 ( 11-13/16" )	170 ( 6-11/16" )	45	100	230	-	130	250	-	16.5 (36 lbs)	81	
AR2-K400	400 ( 15-3/4" )	230 ( 9-1/16" )	45	150	270	330	130	280	350	15 (35 lbs)	134	
AR2-K500	500 ( 19-11/16" )	290 ( 11-27/64" )	45	190	340	430	130	280	450	13 (30 lbs)	166	