

SSR-9 LINEAR BALL SLIDE

MOUNTING PLATE ATTACHED

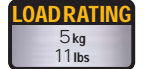

NOTE) M4 bind or truss head screws to be used.



Screws not included.

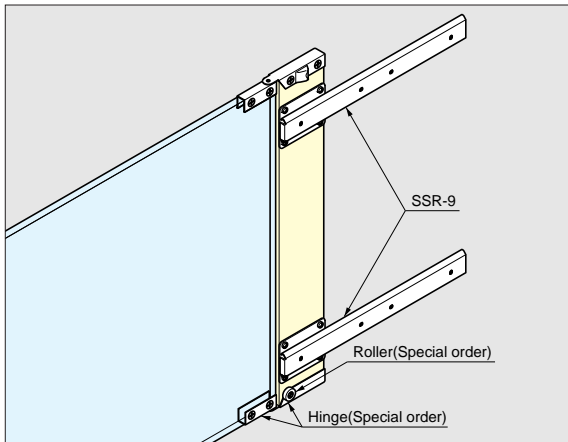
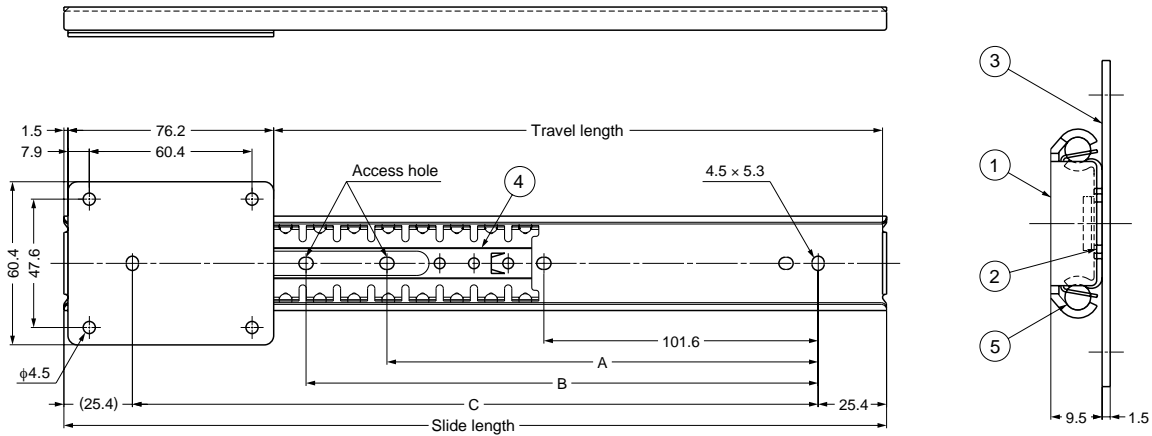

No.	Part	Material
①	Outer Rail	304 Stainless Steel BA
②	Inner Rail	
③	Mounting Plate	
④	Retainer	304 Stainless Steel
⑤	Balls	

Item No.	Slide Length	Travel Length	A	B	C	# of Holes	Load Rating (kg/pair)	Weight (g)	Box (pcs)
						Outer Rail			
SSR-9-12	304.8 (12")	225.6 (8-7/8")	-	152.4	254	4	5 (11 lbs)	290	20
SSR-9-14	355.6 (14")	276.4 (10-7/8")	-	203.2	304.8	4	5 (11 lbs)	330	20
SSR-9-16	406.4 (16")	327.2 (12-7/8")	-	254	355.6	4	5 (11 lbs)	360	20
SSR-9-18	457.2 (18")	378 (14-7/8")	203.2	304.8	406.4	5	5 (11 lbs)	390	20
SSR-9-20	508 (20")	428.8 (16-7/8")	228.6	355.6	457.2	5	5 (11 lbs)	430	20
SSR-9-22	558.8 (22")	479.6 (18-7/8")	254	406.4	508	5	5 (11 lbs)	460	20
SSR-9-24	609.6 (24")	530.4 (20-7/8")	279.4	457.2	558.8	5	5 (11 lbs)	500	20
SSR-9-26	660.4 (26")	581.2 (22-7/8")	304.8	508	609.6	5	5 (11 lbs)	530	20
SSR-9-28	711.2 (28")	632 (24-7/8")	330.2	558.8	660.4	5	5 (11 lbs)	560	20